





**VERSATRUSSE**

A Division of 622254 Ont. Inc.

## FAX TRANSMISSION

To: Irene Date: May 16/17

Company: Indaba Trading Pages: , including this cover sheet.

Fax Number: From: Gordon O'Connor

Subject:

### COMMENTS:

The original estimate has a 25% dealer discount applied to all the items. I have increased the discount to 30% and adjusted the taxes to just GST.  
This is the best pricing I can offer you.

Thanks  
Gordon

888-430-7613

Versatruss (a division of 1859936 Ontario Inc.)

5028 Highway 43

Perth, ON

K7H 3C7

# Estimate

| Date      | Estimate # |
|-----------|------------|
| 5/16/2017 | 4108       |

| Name / Address   |
|--|
| Indaba Trading Ltd.<br>1067 Herring Gull Way Unit 2<br>Parksville, BC<br>V9P 2N1 |

| Project |
|---------|
|         |

| Description        | Qty | Rate         | Total        |
|--------------------|-----|--------------|--------------|
| 14" x14" base      | 4   | 52.50        | 210.00       |
| 2 way 90           | 4   | 129.50       | 518.00       |
| 4 way +            | 2   | 199.50       | 399.00       |
| 3' tri truss       | 2   | 91.00        | 182.00       |
| 6 1/2' tri truss   | 4   | 140.00       | 560.00       |
| 8' tri truss       | 2   | 161.00       | 322.00       |
| 10' tri truss      | 5   | 189.00       | 945.00       |
| 8' brace           | 4   | 70.00        | 280.00       |
| Freight to Toronto | 1   | 195.00       | 195.00       |
| GST On Sales       |     | 5.00%        | 180.55       |
|                    |     | <b>Total</b> | CAD 3,791.55 |

List of Materials

- 4 x 14" x 14" base
- 4 x 2 way 90
- 2 x 4 way 90
- 2 x 3' tri truss (12")
- 4 x 6 1/2' tri truss
- 2 x 8' tri truss
- 5 x 10' tri truss
- 4 x 8' brace

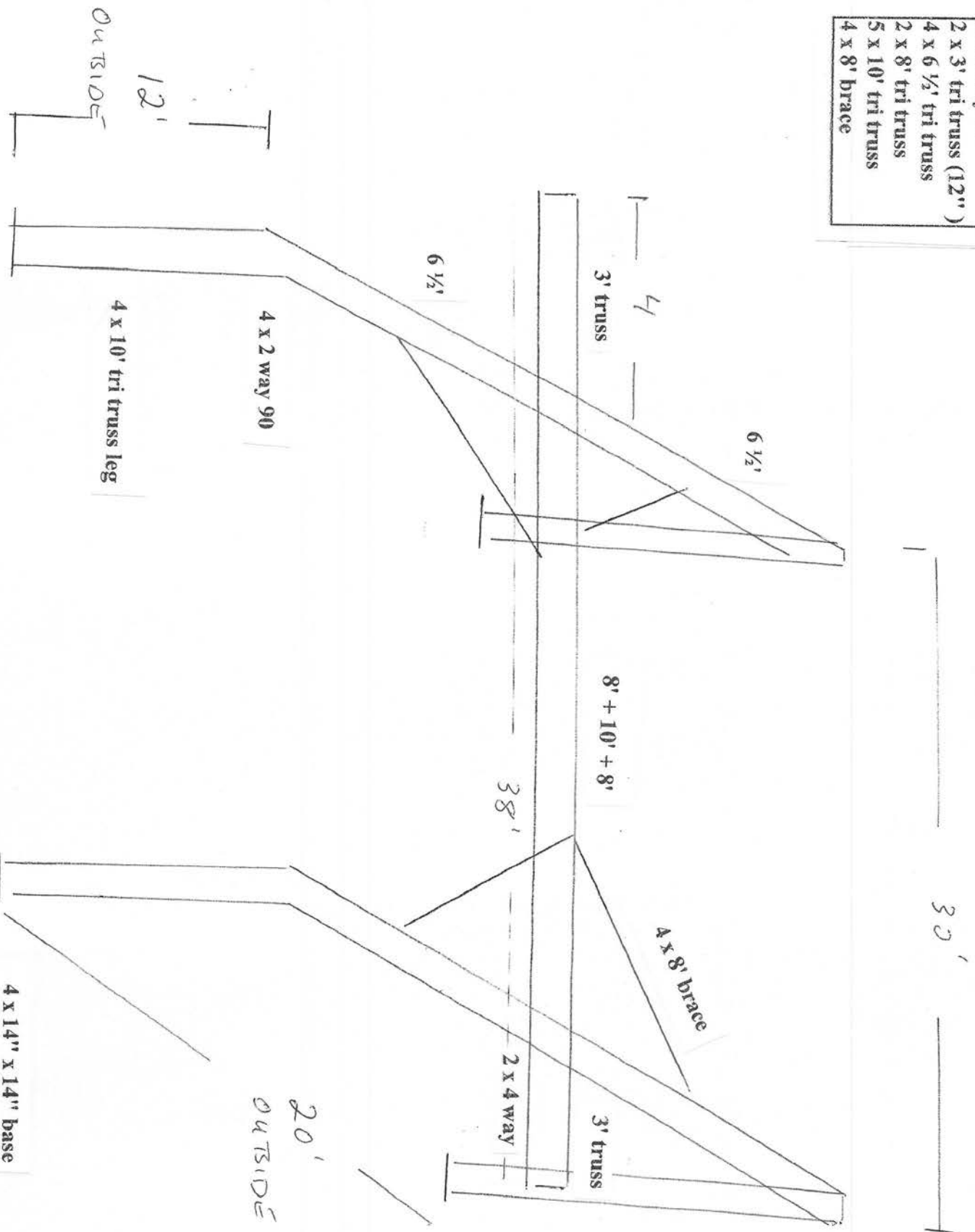



Versatruss (a division of 1859936 Ontario Inc.)

# Invoice

5028 Highway 43  
Perth, ON  
K7H 3C7

| Date      | Invoice # |
|-----------|-----------|
| 6/24/2019 | 12385     |

| Invoice To   |
|--|
| Indaba Trading Ltd.<br>1067 Herring Gull Way Unit 2<br>Parksville, BC<br>V9P 2N1 |

| Ship Date |
|-----------|
| 6/24/2019 |

| Ship To                              |
|--------------------------------------|
| Ship to address in Toronto to follow |

| P.O. No. | Terms | Project |
|----------|-------|---------|
|          |       |         |

| Description                              | Qty | Rate    | Amount       |
|--|-----|---------|--------------|
| 14" x 14" base plates                    | 4   | 52.50   | 210.00       |
| 2 way 90 corner ( apex out )             | 4   | 129.50  | 518.00       |
| 3 way                                    | 6   | 164.50  | 987.00       |
| 4 way                                    | 4   | 199.50  | 798.00       |
| 5' tri truss ( 12" )                     | 2   | 119.00  | 238.00       |
| 6' tri truss                             | 10  | 133.00  | 1,330.00     |
| 10' tri truss                            | 4   | 189.00  | 756.00       |
| 2' tri truss                             | 8   | 77.00   | 616.00       |
| quick clips for new truss                | 144 | 3.00    | 432.00       |
| quick clips for original truss purchased | 69  | 3.00    | 207.00       |
| quick clips for 10" tri truss you have   | 108 | 3.00    | 324.00       |
| Freight to Toronto                       | 1   | 395.00  | 395.00       |
| additional Discount                      | 1   | -350.00 | -350.00      |
| double coupler                           | 4   | 40.00   | 160.00       |
| half coupler weled to plate              | 4   | 30.00   | 120.00       |
| ADDITIONAL DISCOUNTS                     | 1   | -250.00 | -250.00      |
| GST On Sales                             |     | 5.00%   | 324.55       |
| <b>Total</b>                             |     |         | CAD 6,815.55 |
| <b>Payments/Credits</b>                  |     |         | CAD 0.00     |
| <b>Balance Due</b>                       |     |         | CAD 6,815.55 |